

Product Information/Specification Sheet

Studor Mini-Vent (Air Admittance Valve for plumbing ventilation)

Description

The Studor Mini-Vent AAV is an accepted alternative to replace all forms of conventional branch and stack venting. With localised active ventilation of the building drainage system it is proven that the Mini-Vent provides greater protection to prevent induced and self-siphonage of the fixture traps.

The Mini-Vent opens and admits fresh air when the negative (suction) pressure occurs from a fixture discharging into the system. This equalizes the pressure within the system and protects the trap seal. When the flow stops, the Mini-Vent closes by gravity, preventing any transmission of foul air.

The Mini-Vent is used as an alternative to extending the vent pipes through the roof or sidewall.

Features

- Screening on the inside and outside of the Mini-Vent to protect the sealing membrane from foreign objects.
- Protective cover for the air intake and additional insulation against extreme temperatures.
- Ability to divert condensation away from the sealing membrane.
- Prevents the release of foul air from the drainage system.
- Available in white ABS.

Installation

- The Mini-Vent should be connected to the piping in accordance with Studor's installation instructions.
- Refer to your local area regulations for open vent requirements.

Warranty

The Studor products have a "Lifetime of System" warranty. Visit www.studor.net.au.

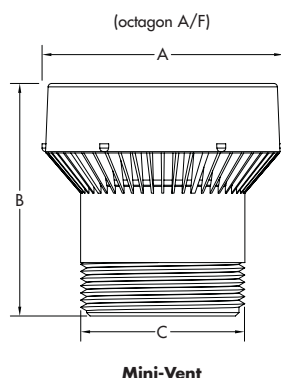

Mini-Vent

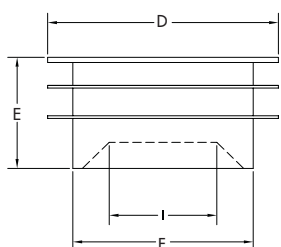

63 mm Connector

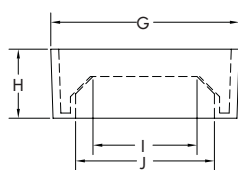

32/40 mm Connector

Note: the components distributed with the Mini-Vent in North America, Canada and Mexico are not illustrated above.

Pipe sizes

AU/NZ
DN 32-50

Dimensions

Dimension	Metric (mm)	Imperial (inches)
A	Ø 70	Ø 2.86
B	67	2.73
C	DN 40	1.50
D	Ø 66	Ø 2.69
E	32	1.31
F	Ø 31	Ø 1.27
G	Ø 52	Ø 2.12
H	Ø 54	Ø 2.20
I	20	Ø 0.82
J	Ø 30	Ø 1.22
K	Ø 40	Ø 1.63

Note: Dimensions for reference only

Performance parameter

Temperature range	-20°C to +60°C -40°F to +150°F (ASSE)
Opening pressure	-70 Pa (-0.010 PSI)
Max. pressure rating tightness	10,000 Pa (1m/40" H ₂ O) at 0 Pa or higher

Air flow capacity	Branch	Stack
AU/NZ	7.5 l/s / 94 FU	7.5 l/s / 7 FU

Materials

Component	Material
Mini-Vent body	ABS
Mini-Vent membrane	Synthetic rubber
63 mm connector	EPDM
32/40 mm connector	Synthetic rubber



AS/NZS 4936

L/Nº 22085